

8828-B

8828-B

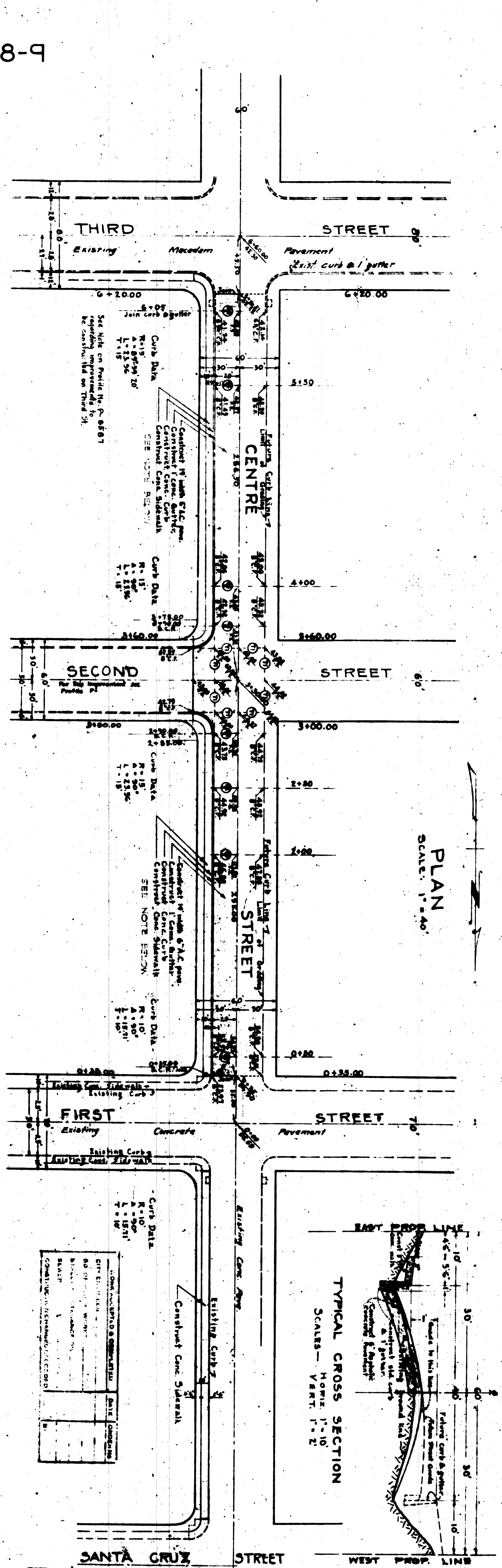

PLAN  
SCALE: 1" = 40'

TYPICAL CROSS SECTION  
SCALE: 1" = 10'

NOTE:  
1. ALL DIMENSIONS ARE TO FACE UNLESS OTHERWISE NOTED.  
2. ALL DIMENSIONS ARE TO FACE UNLESS OTHERWISE NOTED.  
3. ALL DIMENSIONS ARE TO FACE UNLESS OTHERWISE NOTED.

SECOND STREET AND CENTRE STREET IMPROVEMENT DISTRICT  
HARBOR DISTRICT PERMIT D-13

P-8586

HAROLD A. BARNETT  
CIVIL ENGINEER  
35 SOUTH RAYMOND AVENUE  
PASADENA, CALIFORNIA

KATHERINE BASHFORD  
FRED BARLOW, JR.  
LANDSCAPE ARCHITECTS  
816 WEST FIFTH STREET  
LOS ANGELES, CALIFORNIA

ELIOTTEE ELINGWOOD  
MECHANICAL & ELECTRICAL  
ENGINEER  
124 WEST FOURTH STREET  
LOS ANGELES, CALIFORNIA

F. N. ROPP  
STRUCTURAL ENGINEER  
400 EDISON BUILDING  
LOS ANGELES, CALIFORNIA

RANCHO SAN PEDRO HOUSING PROJECT  
HOUSING AUTHORITY  
OF THE  
CITY OF LOS ANGELES

NICHOLAS GILILI  
NICHOLAS GILILI ARCHITECTS  
1500 WEST 11TH STREET  
LOS ANGELES, CALIFORNIA

ARCHITECTS COLLABORATING  
REGINALD D. JOHNSON  
ALLISON & ALLISON  
A. C. ZIMMERMANN

COORDINATING ARCHITECT  
H. ROY KELLEY  
JAMES S. FRIED

APPROVED: HOUSING  
AUTHORITY OF THE CITY OF  
LOS ANGELES, CALIFORNIA

DATE: \_\_\_\_\_

STREET PROFILES  
CENTRE STREET

USA  
CALIFORNIA  
205